

CH2M Overview

Poland Nuclear Supply Chain Forum

13th November 2017



David Ruddock
Account Manager
National Governments

ch2m.SM

CH2M Overview – 71 Years of Technical Excellence!

A global leader in full-service consulting, design, design-build, operations, and programme management services helping our clients build a better world

- Founded 1946
- Headquartered in Denver, Colorado
- **20,000** employees worldwide, **3,762** Europe
- 191 Countries, 146 Offices
- US \$5.24 billion in revenue (Q2 2017)
- **3282** unique clients and **13,785** projects thru Q2 2017

ENR Ranks
CH2MHILL
in **Program Management**
since 2004

#1

ENR Ranks
CH2MHILL
in **Environmental**
since 2006

#1

ENR
Engineering News-Record

#1 Programme Management Firm
#1 Environmental Firm
#2 Construction Management for fee
#1 Consulting/Studies

POWER
Engineering

Engineering Project of the Year 2004

Best Gas-Fired Project of the Year
2011

VERDANTIX

Top Leader in Sustainable
Engineering

2014 **WORLD'S MOST
ETHICAL
COMPANIES**
WWW.ETHISPHERE.COM

World's Most Ethical Companies
2009, 2010, 2011, 2012, 2013, 2014

PMI
Project Management Institute

Project of the Year 2006 and 2011

ch2m

CH2M Ethical values



- Ranked among the World's Most Ethical Companies and top firms in environmental consulting and program management, CH2M in 2016 became the first professional services firm honored with the World Environment Center Gold Medal Award for efforts advancing sustainable development.



CH2M in Poland Capabilities Overview

*World class experience
—local presence*

20 years' experience in Poland and European region.

Over 900 professionals in Poland demonstrates our commitment to the Polish market as well as our ability to serve client needs throughout the region..

We are your single point of contact, taking your project from planning through concept, permitting, design, construction management, and operations.

Poland operations serve the water, transportation, energy, environmental, industrial and manufacturing industries.

As a full service design and consulting company locally, we are positioned to provide industrial and enterprise management solutions throughout Poland.

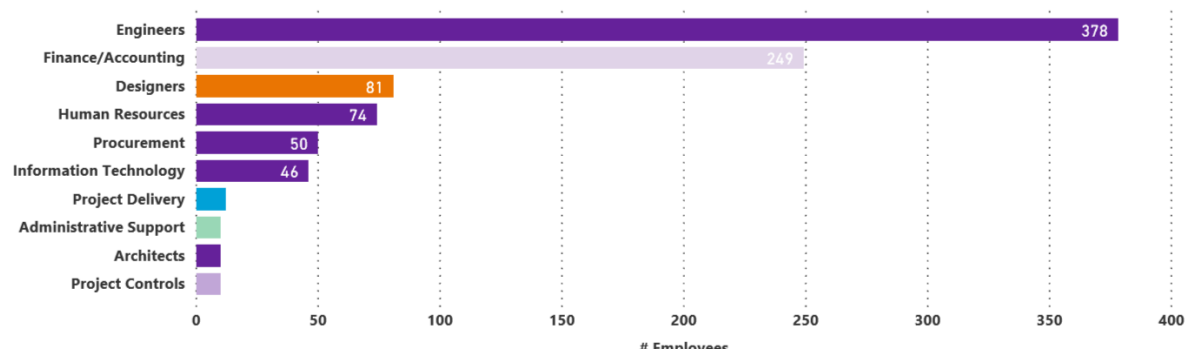

CH2M Nuclear Pedigree

- 25 years experience in nuclear industry
- Circa 3,000 nuclear sector employees, circa 200 UK - 120 security cleared
- Over 200 Nuclear programmes world wide
- NQA-1-compliant Quality Management Program (ISO 9001, 14001)
- Recognised strength in nuclear construction, operations and decommissioning
- Proven safety culture – Target Zero programme



How we add value - *Flexible support models*

CH2M offers a wide range of services across consulting , delivery partner and specialist technical services

Consultancy:

Strategic support

Level 1

- UK MoD MSP
- UK MoD SMOC
- Defence Support Network Transformation



Delivery Partner:

Delivery support

Level 2

- Rolls Royce
- BAE
- Thames Tideway
- Crossrail

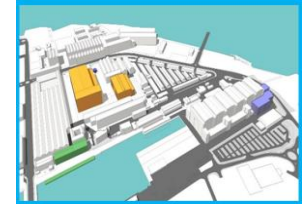

Technical Support:

Specialist technical support

Level 3

- Hinckley Point C
- Dounreay
- USVF Interserve
- Horizon
- Chinese Nuclear Group



CH2M has a credible offering across all Levels, and provides a strong mix of experience-based consultancy, 'hands on' delivery, and technical/engineering specialisations

Broad Capability Offering – *Strength in Depth*

Full CH2M Capability Spectrum



Level 1 Consulting Services



Level 2 Delivery Partner Services



Level 3 Specialist Technical Services

Services Delivered

- P3M transformation
 - Parent Body Organisation (PBO)
 - Organisation development
 - Strategic advisor
 - Technical, Commercial and Financial Advisory
 - P3M related governance and assurance
 - Asset management and improvement
- Programme and Project delivery management
 - Project Controls and Risk Management (inc PMO)
 - Commercial Management
 - Engineering, Procurement and Construction (EPC) Management
 - Site Management and Supervision
 - Quality Assurance and control
 - Decommissioning/Clean Up
 - Waste Management
 - Licensing, consenting and permitting
 - Plant Modification and Shutdown
- Civil and Structural Engineering
 - Concept and Detailed Design
 - Specialist Safety management
 - Safety Case development and management
 - Geotechnical and Seismic investigations
 - Specialist Technical/Support
 - Life extension and Servicing
 - Safety Analysis
 - Traffic planning/studies
 - Environmental investigation
 - Topographical and Ground Investigations
 - Flood Defence & Regulatory Support

Specialist Technical Services

Analysis

Equivalent static methods
Linear elastic analysis
Ansys, LS-Dyna and SAP analysis suites
Response spectrum and time history analysis
Pushover analysis
Non linear dynamic analysis
Soil structure interaction analysis
Dropped loads and impact analysis
Blast analysis
Thermal analysis
Large deformation analysis

Geotechnical

Ground investigations: Geological, geotechnical, hydrogeological
Foundations design / assessments
Probabilistic seismic hazard assessment (PSHA)
Coastal geohazard assessments
Options assessments (barriers / caps etc)
Excavation / blasting studies
Repository design / assessment
Environmental Safety Case support

Engineering Design

Design optioneering
Nuclear design documentation
Civil and structural seismic design
Waste stores and repositories
Outfalls, intakes and cooling water structures
Beyond design basis design and assessment
Large diameter steel pipelines
Maritime structures
Industrial buildings

Engineering Substantiation

Design assessment
Design substantiation
Independent Technical Assessment (ITA)
Beyond design basis assessments
Collapse prevention
Strengthening and retrofit of structures
Life extensions

Why you should choose CH2M

Our track record and reputation is down to our people:

- Superior approach to **client centricity** that capitalises on our culture, unique problem solving capabilities, and focus on providing valued solutions.
- Focus on developing and delivering **solutions** of value to our clients' most complex problems.

Our client focus leads us to shaping winning solutions by:

- Combining the right technical, delivery, and business expertise and innovation, and local regulatory and stakeholder expertise.
- Building simplicity into solutions and adjusting the pace of play to match the complexity of the challenge and expectations of stakeholders.
- Managing risk by evaluating solution development and delivery from the perspective of both the client and CH2M

And in Poland we have a significant local presence: we are accessible, responsive and we understand the local context



Thank You!

Acknowledgements:

Ministerstwo Energii

British Embassy

UK Department for International Trade

NIA

Izba Gospodarcza Energetyki i Ochrony Środowiska



David Ruddock

Account Manager

E dave.ruddock@ch2m.com

M +44 (0) 7464 987969

1 The Square
Temple Quay
Bristol
BS1 6DG
United Kingdom

ch2m.SM